

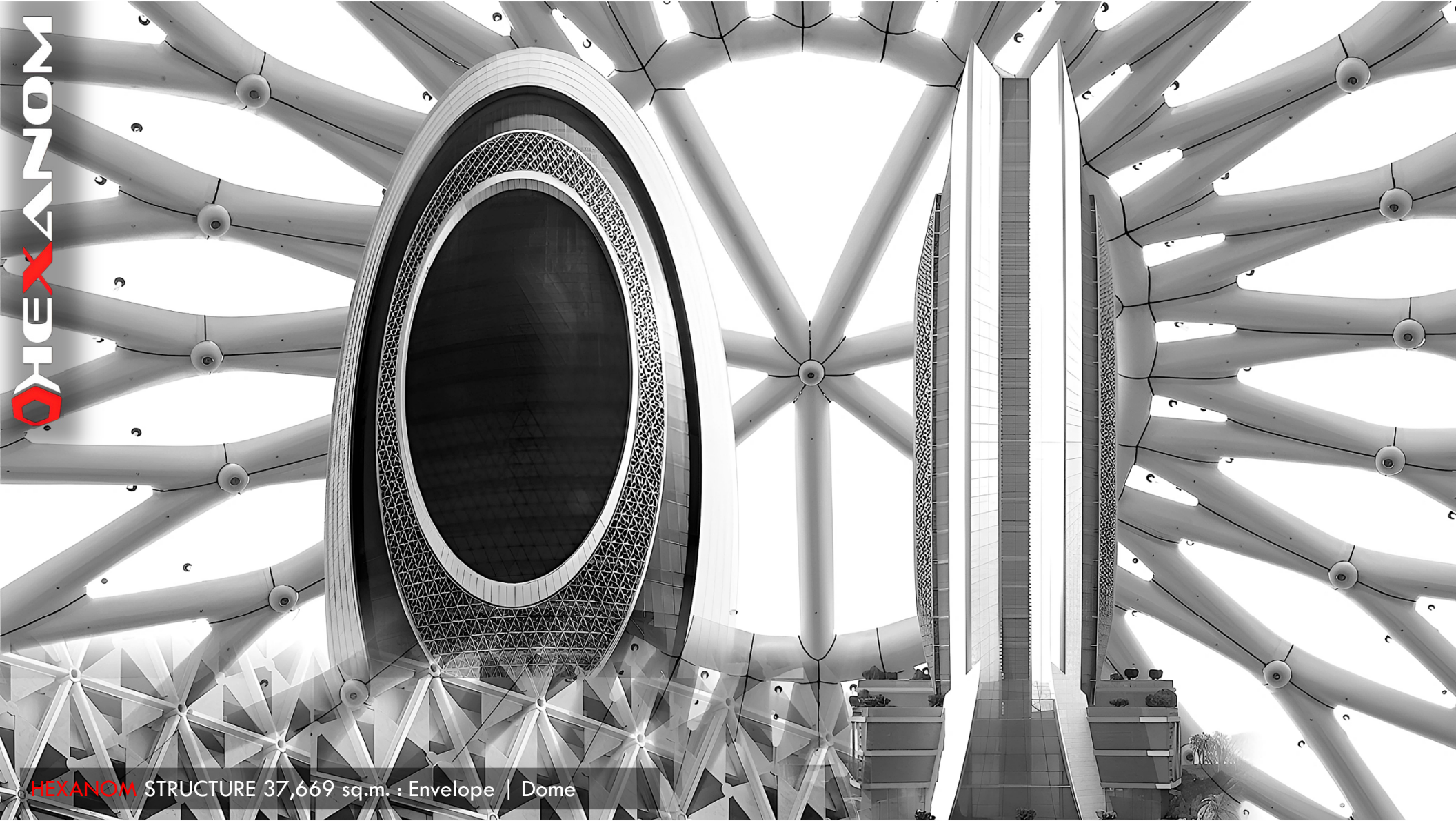

HEXANOM

HEXANOM



HEXANOM STRUCTURE 37,669 sq.m. : Envelope | Dome



Dome : 850 sq.m.

Design with diamond shape openings | Big spans | Innovative ETFE external skin | High-energy resistance properties | Strength over a wide temperature range | Lightweight structure | Incorporation of inner UHPC, while in design stage

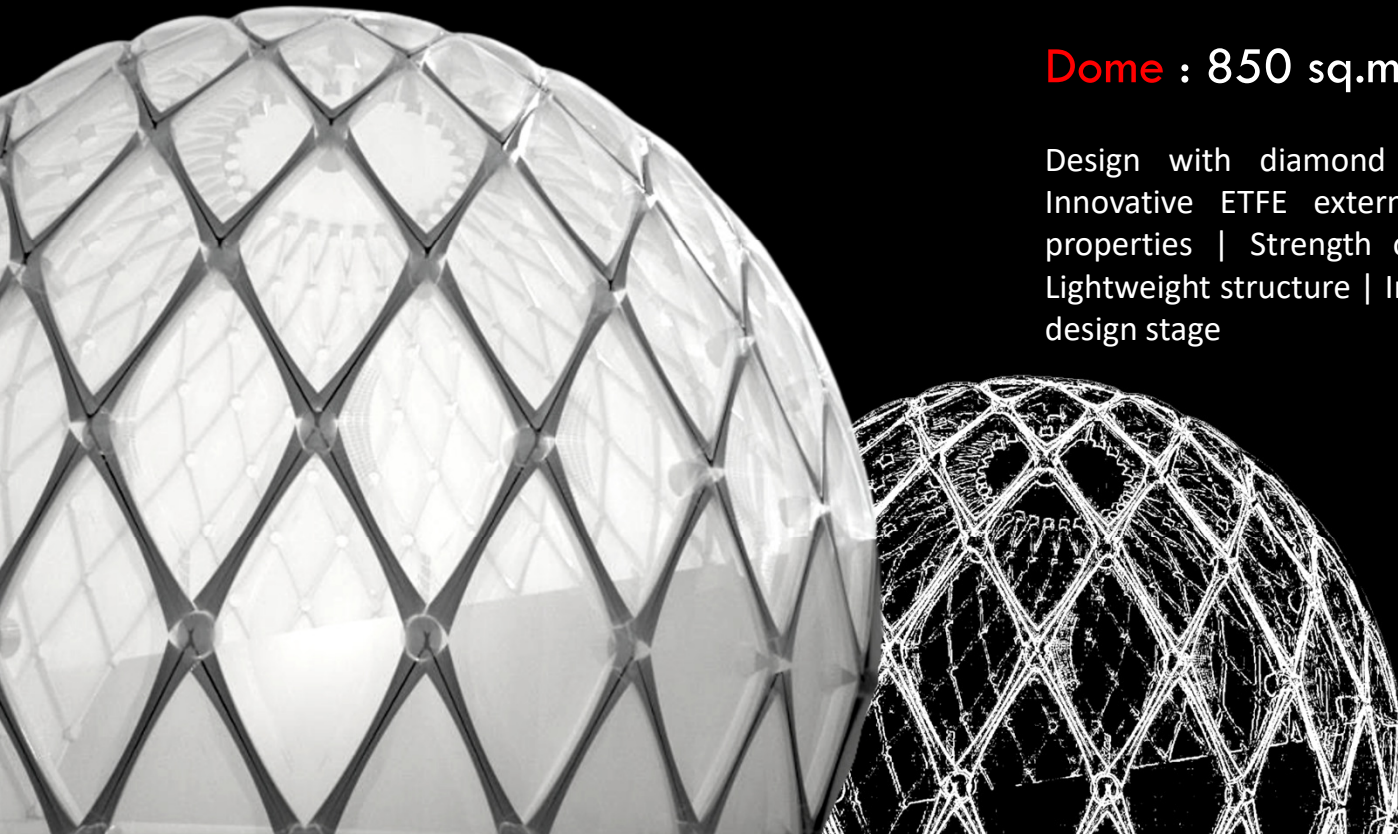

HEXANOM Dome is a special structure, part of a new landmark Tower at Lusail City, State of Qatar, completed in September 2022. With 850sq. meters, HEXANOM Dome carries one of the most contemporary materials in today's design industry and has set the construction world alight with this potentiality. ETFE membrane has outstanding break strength, long lifespan, and transparency to UV light.

HEXANOM system with ETFE membrane welcomes you into the architectural spotlight. Meet the sustainable free form solution where Imagination is the only limitation.

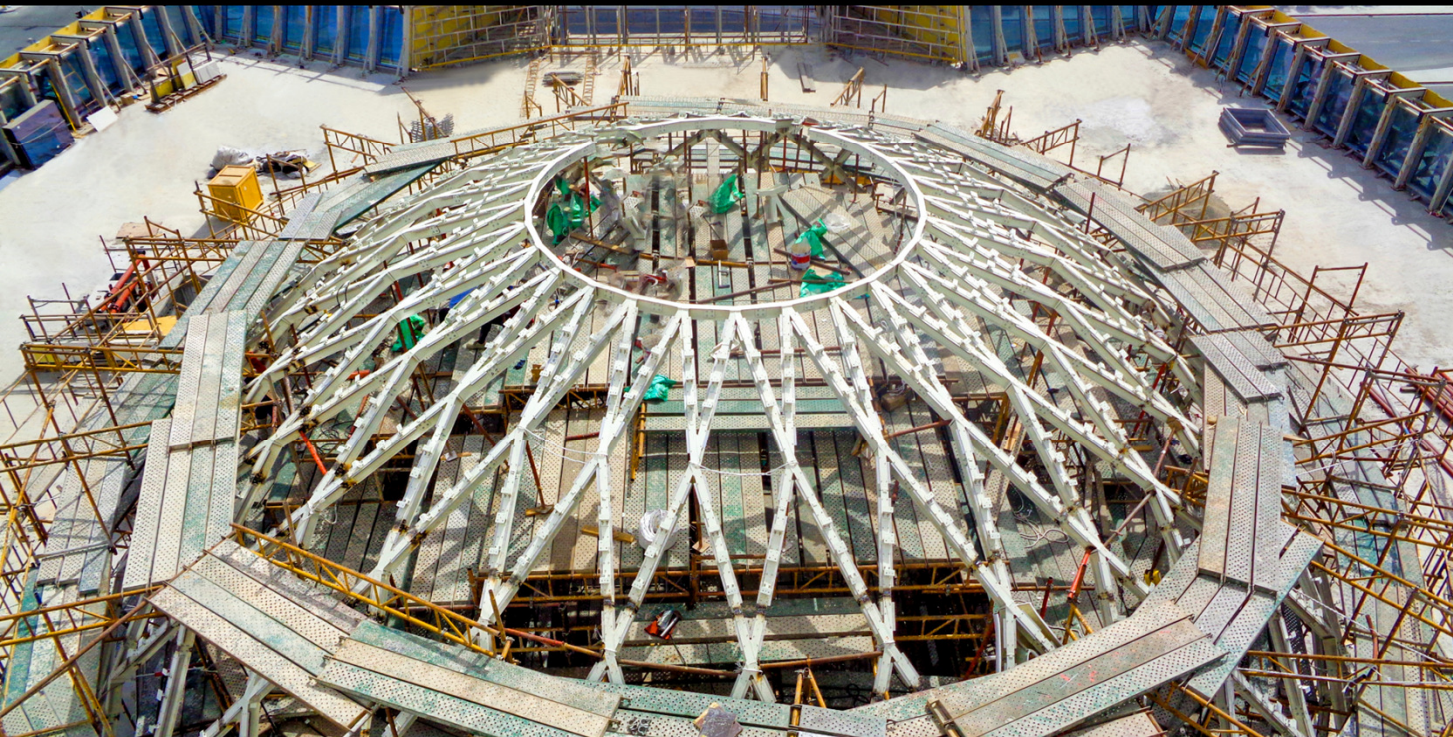



HEXANOM Dome serves as the closing part of shopping mall located at the 3-storey main part of the building



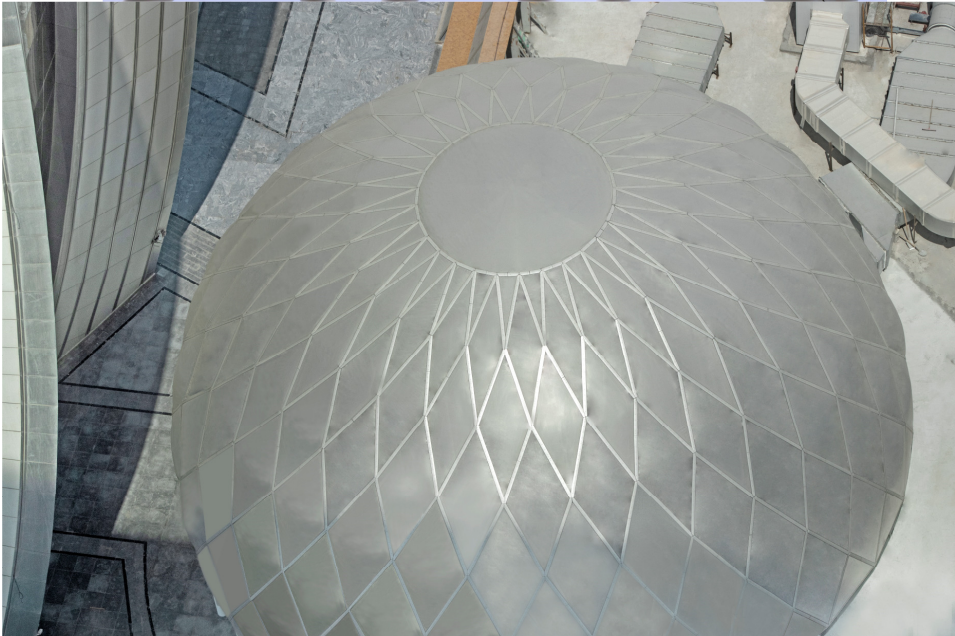
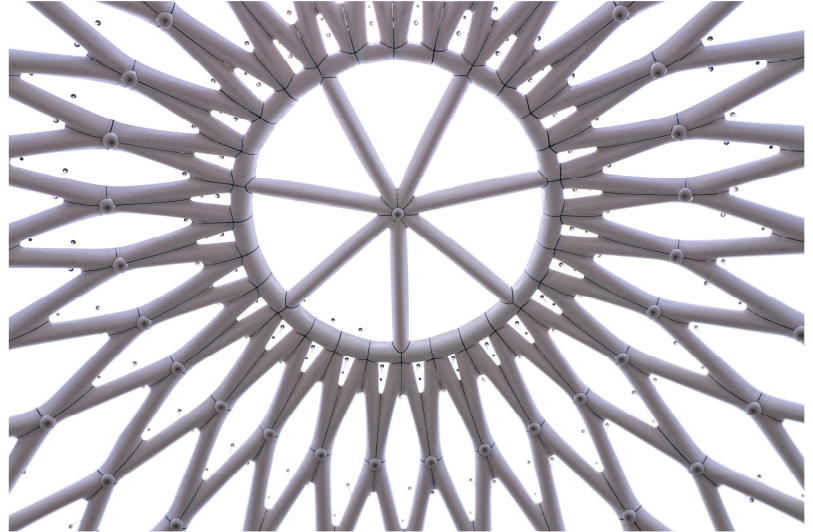
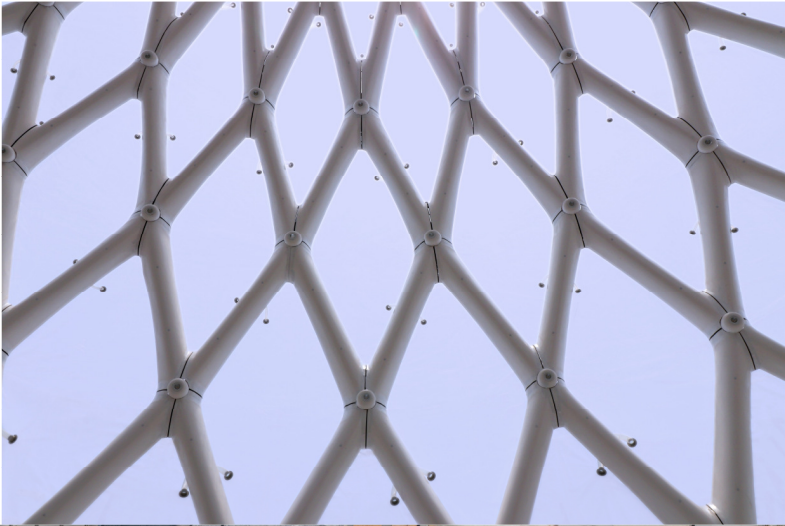



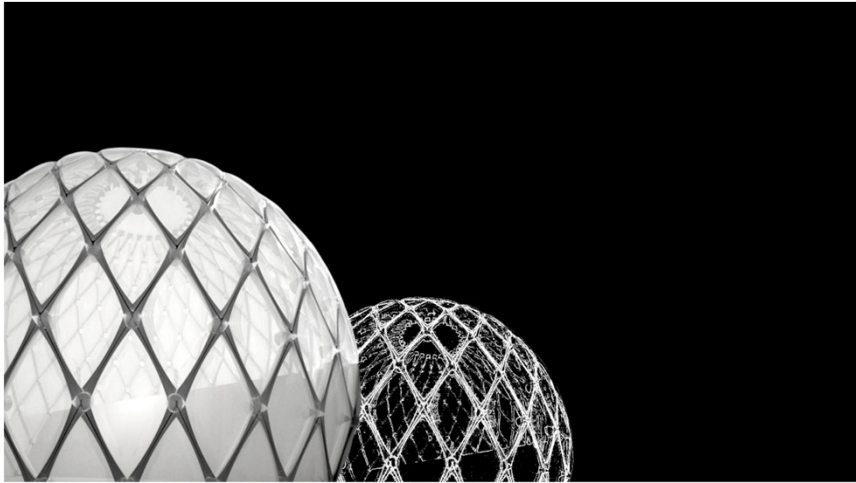
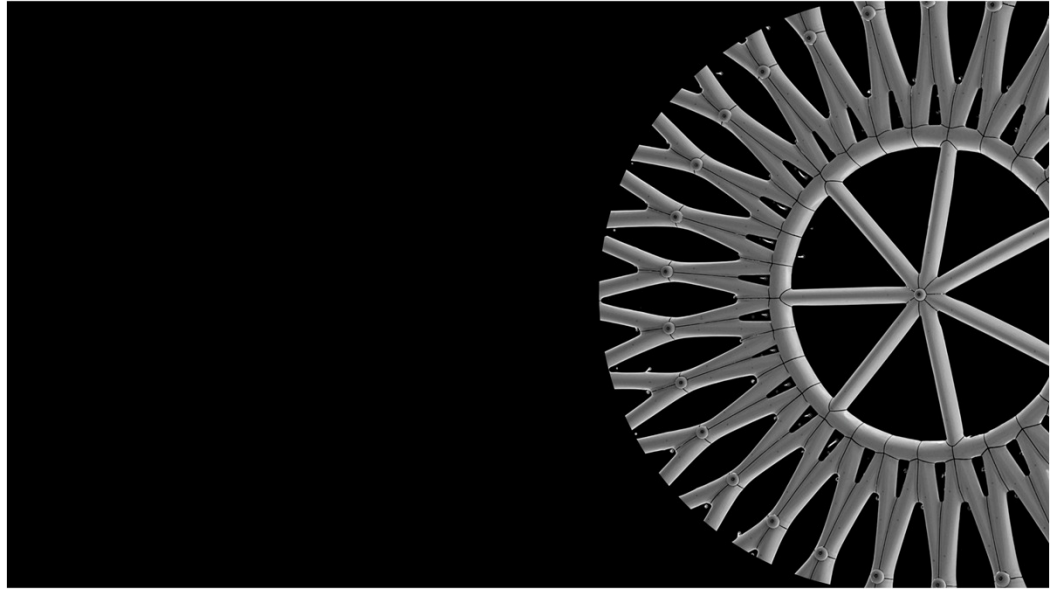
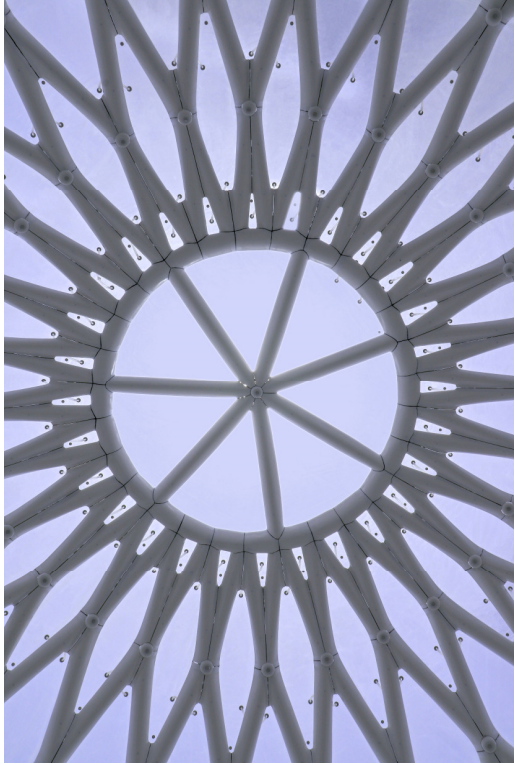

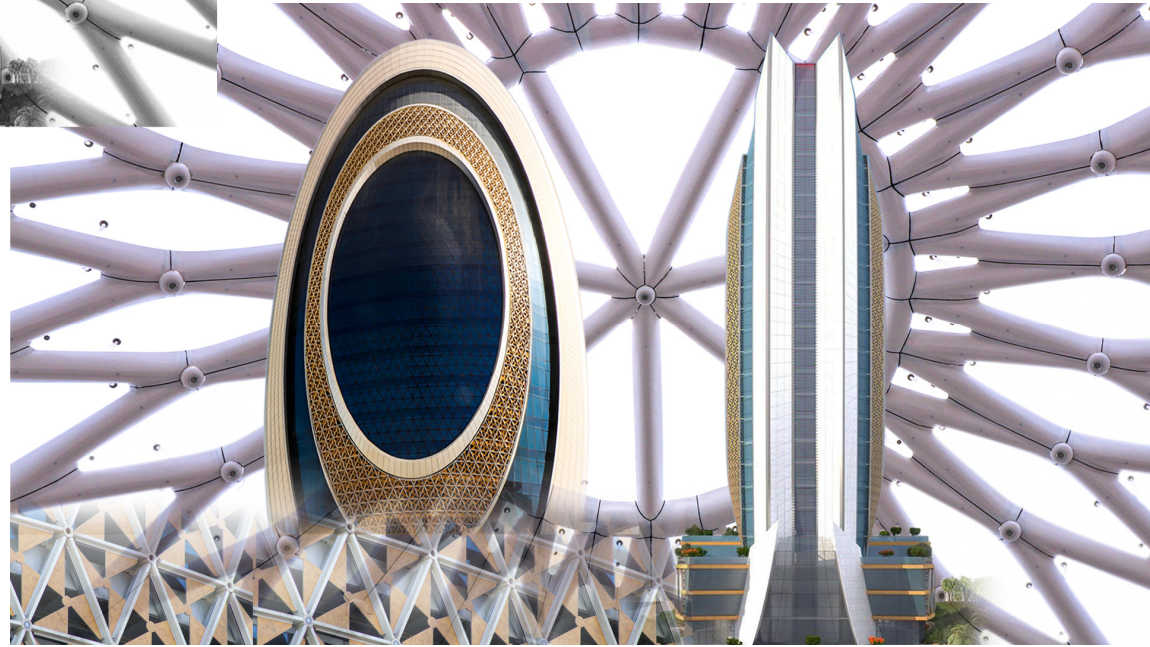
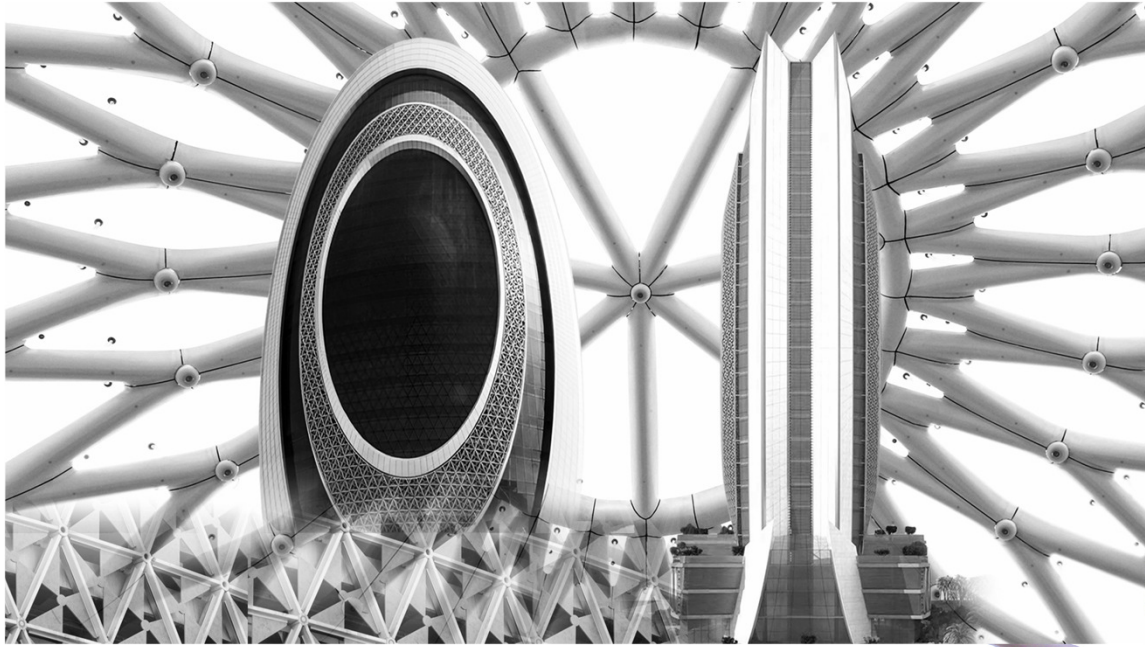

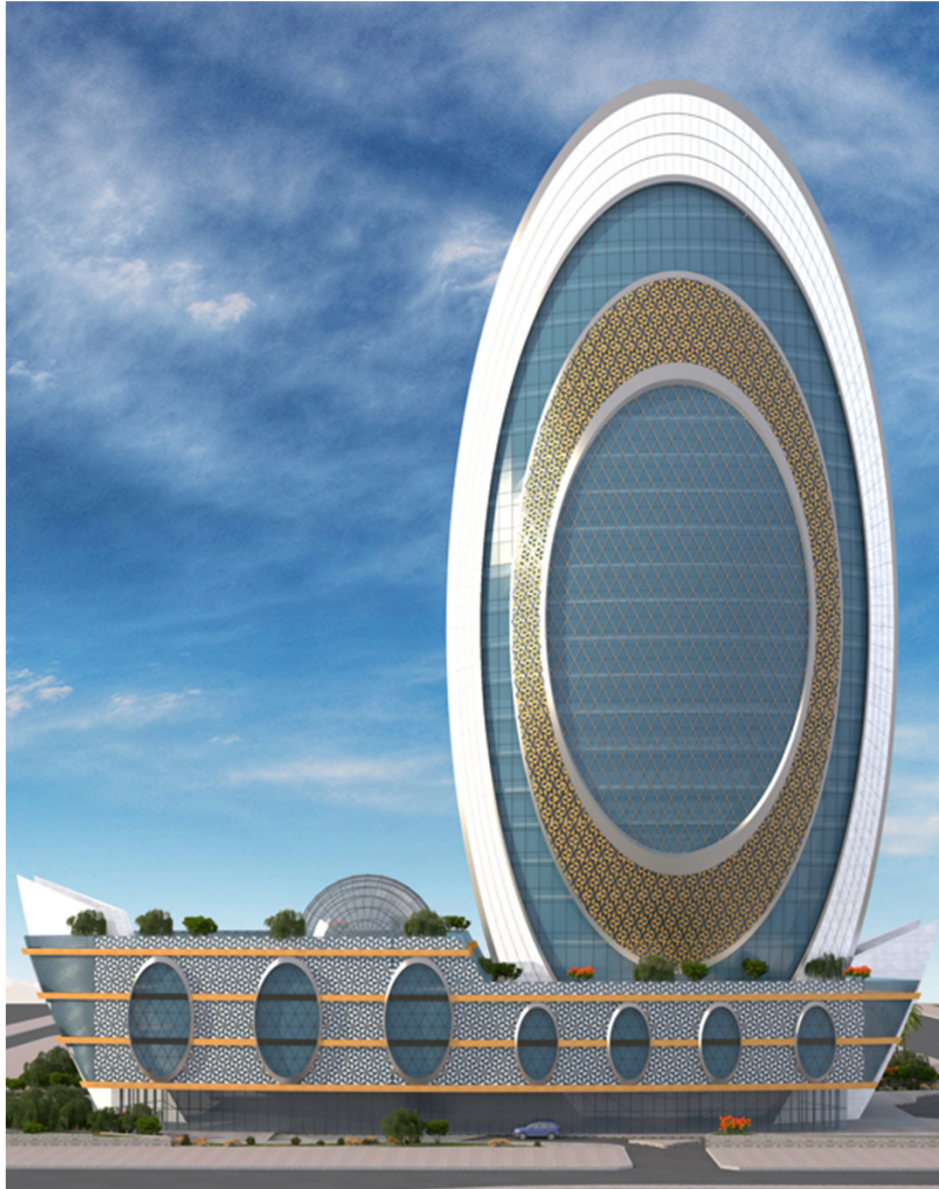

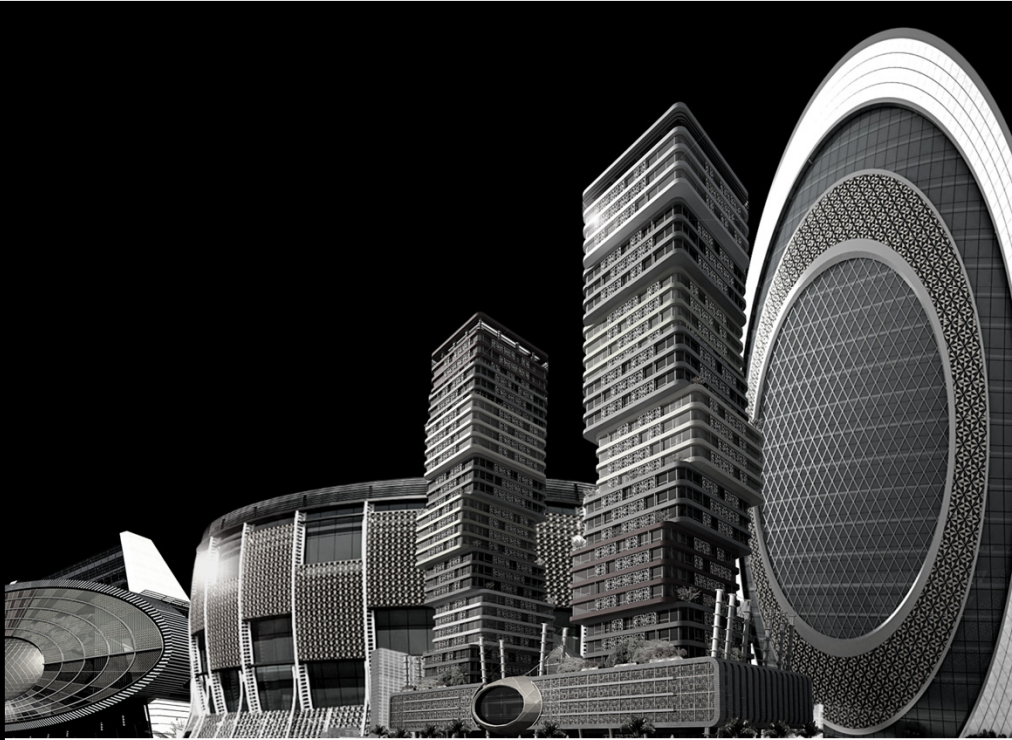
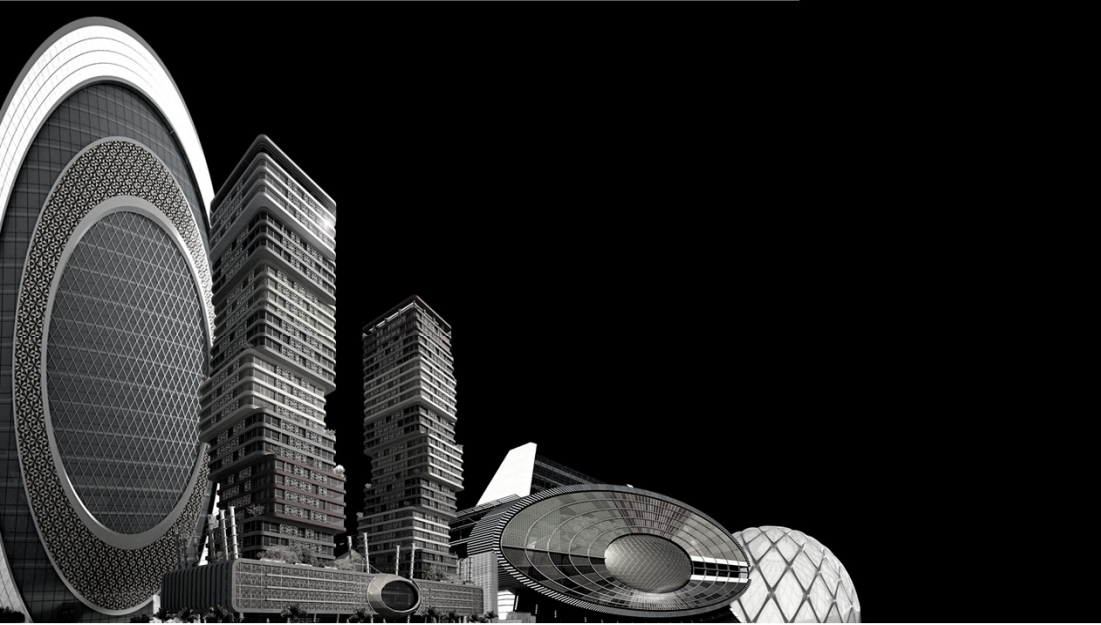







 **Qatar**
Lusail Marina Twin Towers, Tower A, Floor no. 9

 **Cyprus**
Emmanouil Roide str. Kirzis center, Emmanuel
Roide, Kirzis Center, Block D, Office D25

 **China**
No. 32 Makan South Rd, Ma Kan, NanShan,
ShenZhen 518055, Guangdong Province

 Info@hexanom.com

 www.hexanom.com

 +974 6614 8372

Follow us:   HEXANOM  hexanom_structures

